

26 GA. PBR ROOF PANEL LOAD TABLE OVER 15/32" PLYWOOD

DIXIELAND
METALS OF
ALABAMA, LLC.

Buildings having a Roof Mean Height $\leq 20'-0"$; Roof Slope: 2"/12" -6"/12" Gable or Hip Roof
Wind Speeds 115-130 mph, Exp C, Risk Category II, Enclosed Bldg. based on FLORIDA BUILDING CODE 2010

26 GA. PBR PANEL FASTENER SPACING					
ZONE	FASTENER	SUBSTRATE	WIND SPEED ZONE		
			115	120	130
			ON CENTER SPACING	ON CENTER SPACING	ON CENTER SPACING
ZONE 1	#9-15-1-1/2"	15/32" PLYWOOD	24"	24"	24"
ZONE 2	#9-15-1-1/2"	15/32" PLYWOOD	24"	24"	24"
ZONE 3	#9-15-1-1/2"	15/32" PLYWOOD	24"	24"	24"

PANEL DESCRIPTION: MIN. 26 GA. GRADE 80, 36" COVERAGE, 1-1/4" TALL.

PANEL ROLLFORMER: MRS METAL ROOFING SYSTEMS

PANEL FASTENER: (1) #9-15 x 1-1/2" WOODGRIP W/ SEALING WASHER, 1/4-14x7/8" LAP SCREW AT 24" O.C. IN PANEL SIDELAP.

MAXIMUM ALLOWABLE PANEL UPLIFT PRESSURE: 56.75 PSF @ 24" FASTENER SPACING BASED ON TAS 125, UL 580/UL 1897 TESTING.

SUBSTRATE: MIN. 15/32" THICK PLYWOOD, APA RATED. PLYWOOD MUST BE DESIGNED IN ACCORDANCE WITH FBC 2010.

ROOF SLOPE: ON ROOF SLOPES LESS THAN 3:12, LAP SEALANT MUST BE USED IN PANEL SIDE LAPS.

LOAD TABLE BASED ON WIND PRESSURES CALCULATED PER ASCE 7-10 ($K_d=0.85$) MULTIPLIED BY 0.6 PER FBC 2010, SECTION 1609.1.5.

LOAD TABLE DOES NOT INCLUDE OVERHANG ZONES

TYPICAL FASTENER PATTERN

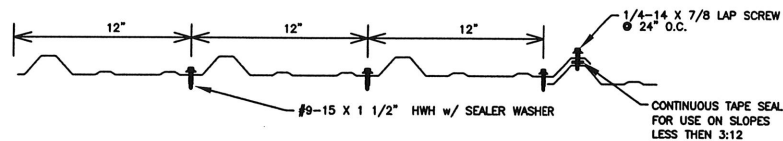

FASTENER PATTERN AT PANEL ENDS

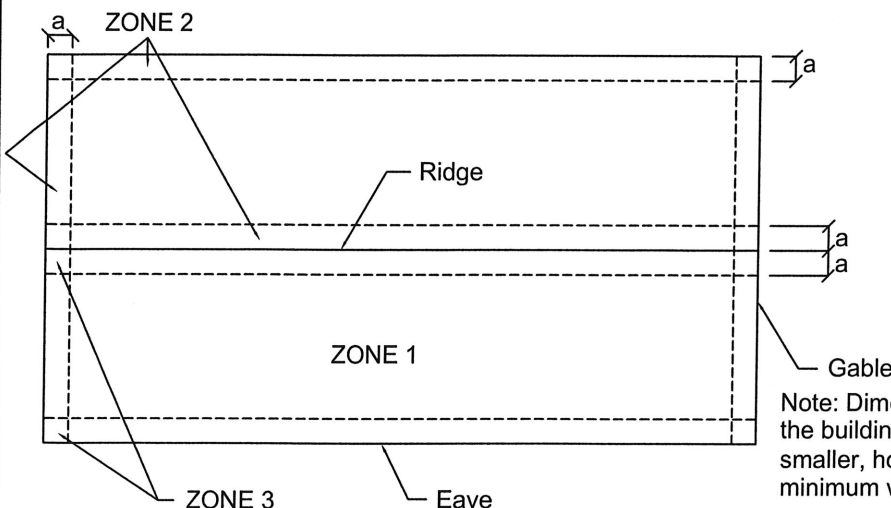
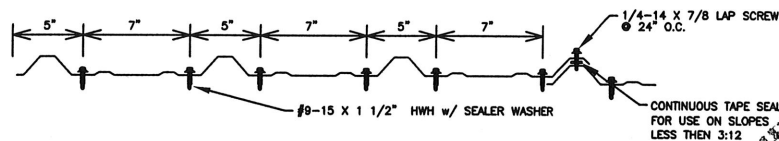

State of Florida
C.O.A.
25778

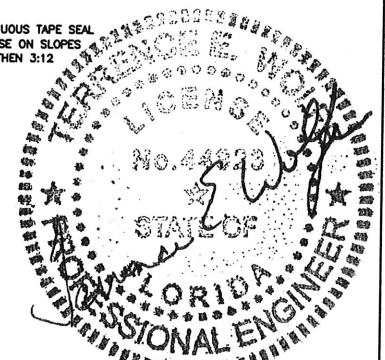

AUG 08 2012

Note: Dimension (a) is defined as 10% of the minimum width of the building or 40% of the mean height of the roof, whichever is smaller, however, (a) cannot be less than either 4% of the minimum width of the building or 3 feet.